

NCY FORGED 4 PISTONS CALIPER



INSTALLING MANUAL

1. IF PRODUCT IS BROKEN OR INCOMPLETE, PLEASE DO NOT USE IT. CONTACT WITH LOCAL DEALER ASAP.
2. ONLY AVAILABLE FOR DOT3/DPT4 BRAKE FLUID.
3. WHEN INSTALLING, PLEASE MAKE SURE THERE IS NO AIR IN THE BRAKE TUBE, BRAKE MASTER ASSY AND CALIPER. IF THERE IS AIR INSIDE, THAT WILL MAKE BRAKEFORCE NOT WORK.
4. DO NOT TOUCH CALIPER AFTER RIDING SCOOTER BECAUSE OF HIGH TEMPERATURE.
5. CONFIRM BRAKE FIXED METAL SPRING INSTALLING CORRECTLY AND AIR WASTEGATE SCREW TURNING UPWARD.
6. WHEN INSTALLING, BRAKE DISK MUST INSTALL IN THE CENTER OF CALIPER, $|A - B| \leq 1 \text{ mm}$.
7. DISTANCE FROM FRICTION FACE OF BRAKE PAD TO OUTER OF BRAKE DISK IS $0 < X < 1 \text{ mm}$.
8. RECOMMEND TORQUE VALUE FOR EACH SCREW INSTALLING

- a. CALIPER FIXED SCREW: 27 ~ 23kgf-m
- b. AIR WASTEGATE: 6~9kgf-m
- c. BRAKE TUBE FIXED SCREW: 3.5kgf-m
- d. BRAKE FIXED METAL SPRING
- e. BRAKE PAD FIXED PIN

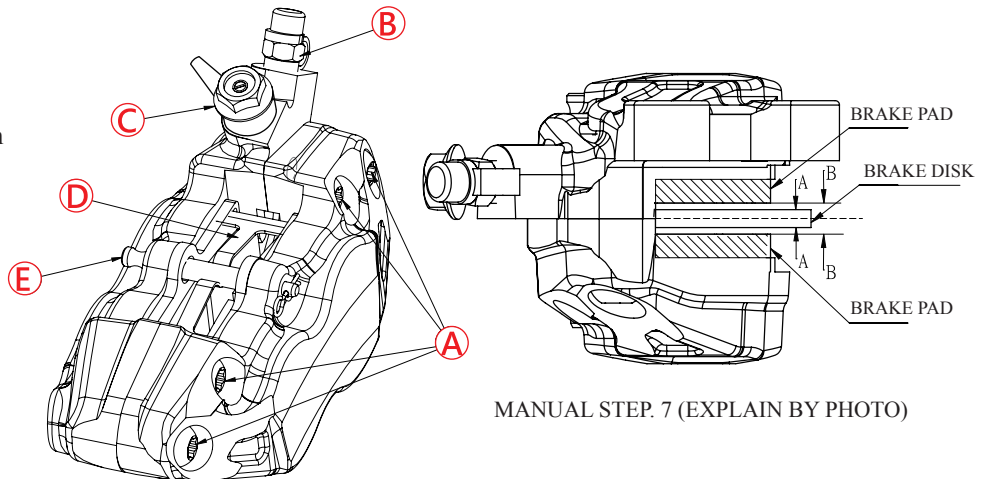

MANUAL STEP. 7 (EXPLAIN BY PHOTO)

9. PLEASE USE THE CORRECT METHOD TO MOVE THE PISTON.

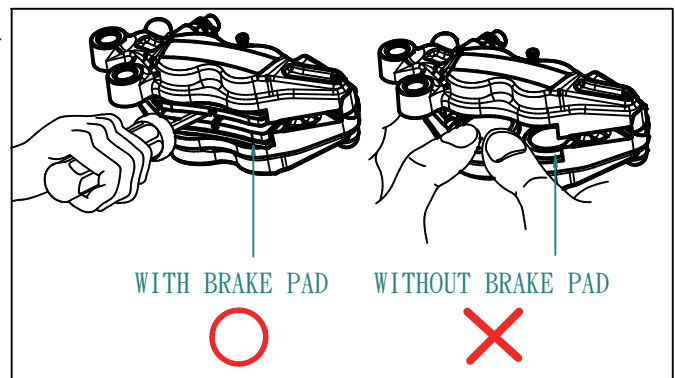

NOTICE:

1. DURING THE BRAKE-IN PERIOD OF BRAKE DISK & BRAKE PAD, THERE WILL BE SOME STRANGE SOUND, SMELLING, AND VIBRATING. THESE ARE THE NORMAL CONDITIONS; PLEASE DON'T WORRY TO USE IT.
2. THIS PRODUCT IS HIGH PERFORMANCE BRAKE SYSTEM PRODUCT. IT SHOULD BE INSTALLED BY PROFESSIONAL ENGINEER. NOT SUGGEST TAKING APART BY PERSON. IF THE PRODUCT IS BROKEN OR THERE IS DAMAGE TO HUMAN OR PROPERTY BECAUSE OF WRONG INSTALLING METHOD OR DISASSEMBLING BY YOURSELF, OUR COMPANY WILL NOT TAKE LEGAL RESPONSIBILITY.

MAINTAIN & CLEAN

1. PLEASE DON'T USE ORGANIC SOLVENT TO CLEAN CALIPER SURFACE.
2. THIS PRODUCT BELONGS TO SAFE PARTS, SO PLEASE MUST LOOK FOR THE PROFESSIONAL SHOPS TO MAINTAIN & CLEAN