

- 感謝您購買本公司產品，在此向您致上萬分謝意。使用之前，請您務必詳讀並參照安裝說明，並且正確組裝。
- Before installing, please read Installing Manual well.

■■ **1-1 配件示意圖：Accessories**

凸輪軸 / CAMSHAFT

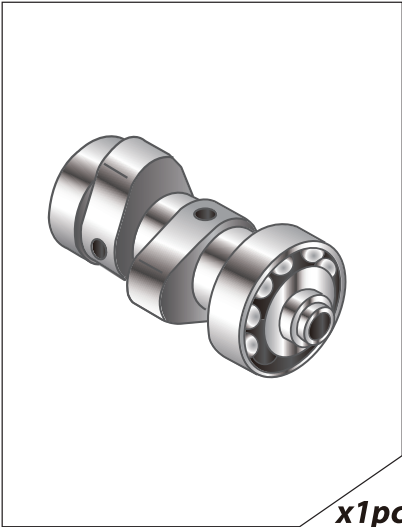

x1pc

1.TDC (上死點) 記號對正步驟:

- 使用適當的板手反時針旋轉曲軸。確認曲軸電盤“T”對上曲軸箱正時記號“A”，再將凸輪軸 | “B”對準缸頭 ◀ “C”
- 當凸輪軸鏈輪上的記號 | “B”. 與汽缸頭固定記號位置 ◀ “C”.對正，即表示活塞正位於TDC (上死點) 位置。

2.壓縮TDC (上死點) 檢查方式:

- 當發電機轉子上“T”記號與“A”對齊，汽缸頭上的 | “B”對齊 ◀ “C” 進/排氣搖臂上有閥門間隙時，表示活塞正位於壓縮上死點。如果不是，在順時針旋轉曲軸一圈，重複上述檢查步驟。

1.TDC Top Dead Center Installtion Procedure:

- Make sure the fly wheel mark “T” align with Timing mark “A”.Rotate camshaft mark “B” to align with cylinder head “C”.
- When camshaft sprocket mark “B” align with cylinder head mark “C”. It means the piston is in the right TDC position.

2.Compression TDC check:

- When fly wheel mark “T” align with crankcase mark “A” . and the camshaft mark “B” align with cylinder head mark “C”. The rocker arm should have clearance between rocker arm and valve. The piston will in the right compression TDC position. If not, please repeat the procedure till right position.

■■ **2-1 汽缸頭拆卸說明-示意圖 / Installtion Diagram**

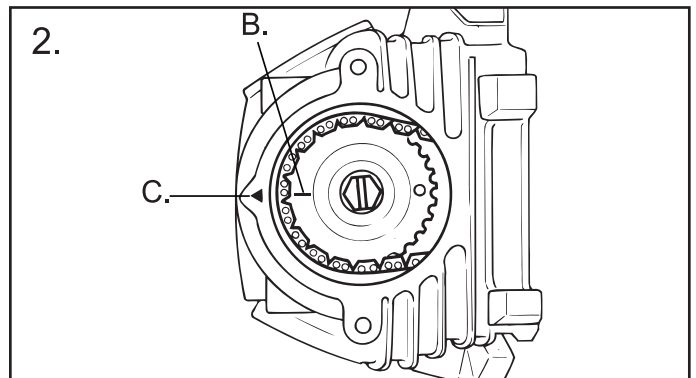
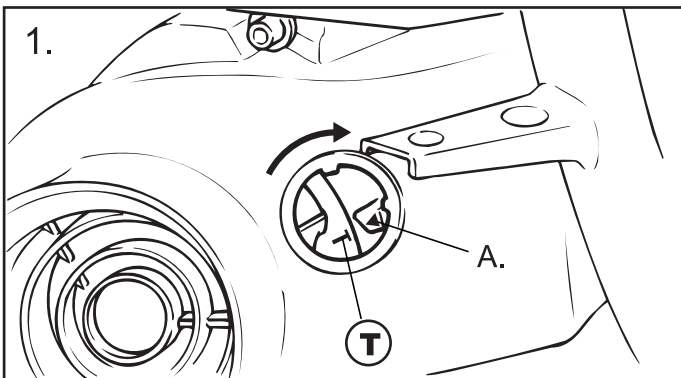

■■ **2-2 安裝凸輪軸 示意圖 / Installtion Diagram**

規 格 / SPEC	間 隙 / CLEARANCE
進汽 IN / Intake valve lash	0.13~0.18mm
排汽 EX /Exhaust valve lash	0.15~0.21mm

